



U.S. Highway 10/169 Improvement Project

Access During Construction for vehicles less than 10 ft tall



Subject to change. Check website for most current information.

AnokaHwy10.com

MAP LEGEND

- Two highway lanes open (one lane each direction)
- Road closed
- Open/alternate route
- Open route with restriction (see note)
- Highway ramp OPEN
- Highway ramp CLOSED
- Temporary traffic signal

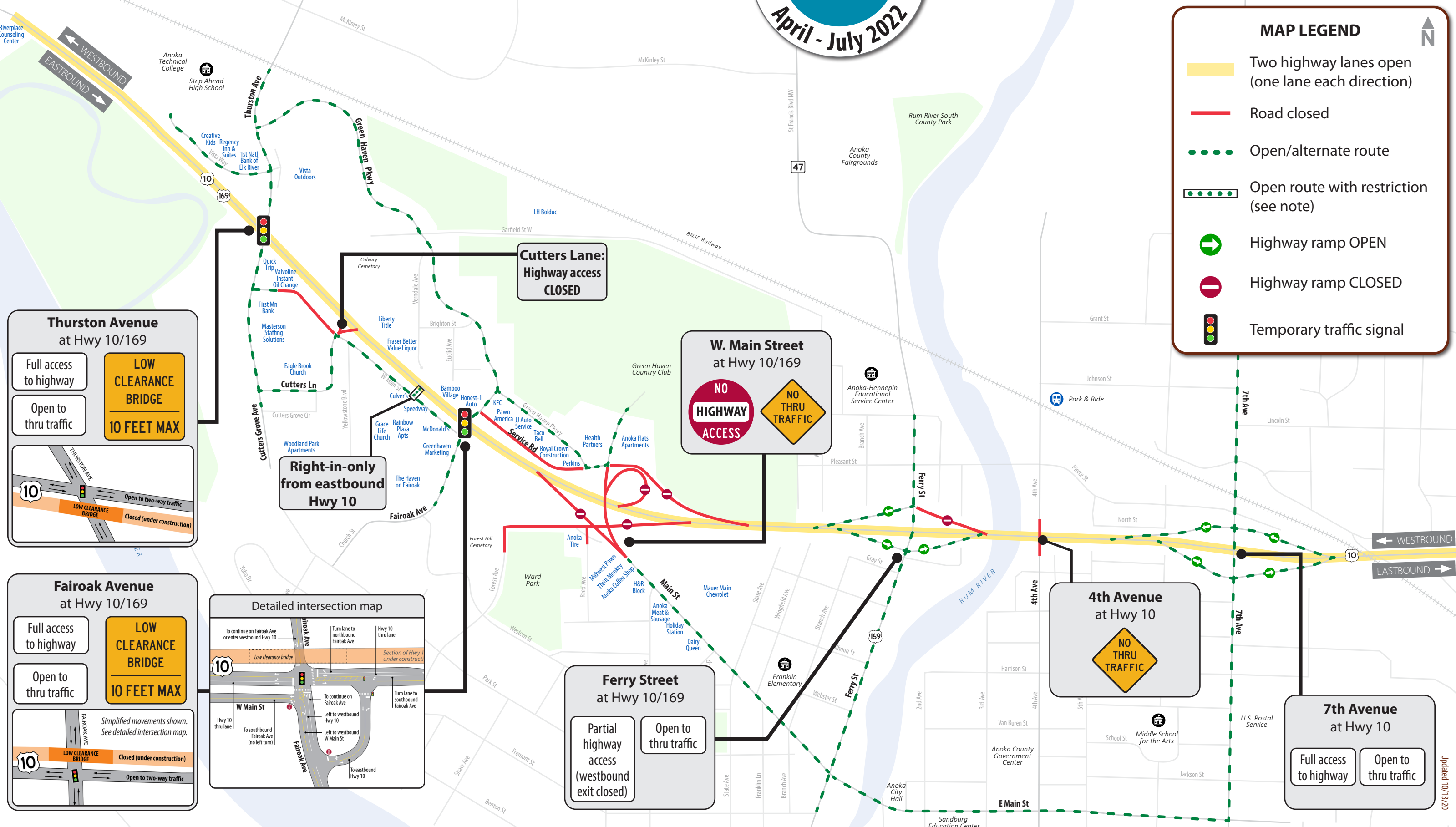

Thurston Avenue at Hwy 10/169

Full access to highway

Open to thru traffic

LOW CLEARANCE BRIDGE
10 FEET MAX

Fairoak Avenue at Hwy 10/169

Full access to highway

Open to thru traffic

LOW CLEARANCE BRIDGE
10 FEET MAX

Simplified movements shown. See detailed intersection map.

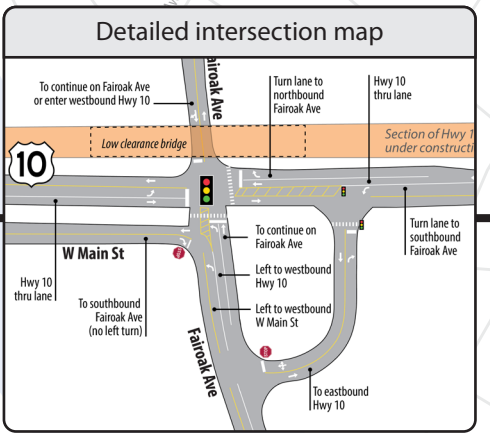

Cutters Lane: Highway access CLOSED

W. Main Street at Hwy 10/169

NO HIGHWAY ACCESS

NO THRU TRAFFIC

Right-in-only from eastbound Hwy 10

Ferry Street at Hwy 10/169

Partial highway access (westbound exit closed)

Open to thru traffic

4th Avenue at Hwy 10

NO THRU TRAFFIC

7th Avenue at Hwy 10

Full access to highway

Open to thru traffic